

HIGHLIGHTER™ LED MINI-LIGHTBARS

bulletin# M1505 | version: 907

available in: 



Truly Unique LED Mini-lightbar

The HIGHLIGHTER™ LED mini-lightbar is a low profile, modular design of Federal Signal's industry leading HIGHLIGHTER mini-lightbar. The HIGHLIGHTER LED combines the high performance ROC™ (Reliable On-board Circuitry) with the high efficiency SOLARIS® reflector design. The innovative reflector design offers uniform 360-degree light distribution, which means no dark spots or shadows.

Easily Switch Flash Patterns

The HIGHLIGHTER LED mini-lightbar offers a variety of user selectable flash patterns (20+) and additional features. Incorporated into the top of the dome is a truly innovative feature called MAGNET SELECT™, which allows users the ability to easily switch flash patterns through the use of a magnet (patent pending).

Synchronize or Alternately Flash Complete Systems

Multiple HIGHLIGHTER LED lights can be wired together or with a variety of other LED light heads, allowing users to customize complete warning packages. When used in complete systems, the LED lights can be synchronized together or alternately flashed with all the lights displaying the chosen flash pattern. Another built-in feature is the two-channel high-side flasher. Any light heads (up to 7.5 amps per channel) can be synchronized to flash in conjunction with the HIGHLIGHTER LED. These features are easily accessible at the bottom of each unit.

Wide Variety of Mounting Options

The compact HIGHLIGHTER LED mini-lightbar measures a mere 2.7 inches high (permanent mount) making it ideal for amber, police, and fire applications that place a premium on space savings. The HIGHLIGHTER LED is available in permanent, magnetic, suction-cup magnetic mounts, and a variety of other custom mounting options. All HIGHLIGHTER LED models meet SAE J845, Class 1 specifications.



HIGHLIGHTER LED shown with riser mount kit option.

FEATURES

- Low-profile modular design utilizing industry leading HIGHLIGHTER styling and mounting footprint.
- Incorporates ROC LED technology.
- Available in solid or split color combinations.
- 24 VDC models available (solid color only).
- Uniform 360-degree light distribution; no dark spots or shadows.
- More than twenty user selectable flash patterns.
- Magnet Select feature; easily switch flash patterns using a magnet (magnet key chain included).
- Synchronize or alternately flash with multiple HIGHLIGHTER LED units or a variety of other LED light heads.
- Contains two-channel high-side flasher that synchronizes other light heads (up to 7.5 amps per channel).
- Variety of mounting options.

APPROVALS

- Meets SAE J845 Class 1 specifications

HOW TO ORDER

Model	LED Color	Lens Color*	Solid/Split Color	12 or 24 VDC	Mount Type
454200	(02) amber, (03) blue, (04) red, (06) green	A,B,R,G	solid	12 VDC	Suction-Magnet
454200	(25) amber, (35) blue, (45) red, (05) white, (65) green	C	solid	12 VDC	Suction-Magnet
454201	(02) amber, (03) blue, (04) red, (06) green	A,B,R,G	solid	12 VDC	Permanent
454201	(25) amber, (35) blue, (45) red, (05) white, (65) green	C	solid	12 VDC	Permanent
454202	(02) amber, (03) blue, (04) red, (06) green	A,B,R,G	solid	12 VDC	Magnet
454202	(25) amber, (35) blue, (45) red, (05) white, (65) green	C	solid	12 VDC	Magnet
454200-24	(02) amber, (03) blue, (04) red, (06) green	A,B,R,G	solid	24 VDC	Suction-Magnet
454200-24	(25) amber, (35) blue, (45) red, (05) white, (65) green	C	solid	24 VDC	Suction-Magnet
454201-24	(02) amber, (03) blue, (04) red, (06) green	A,B,R,G	solid	24 VDC	Permanent
454201-24	(25) amber, (35) blue, (45) red, (05) white, (65) green	C	solid	24 VDC	Permanent
454202-24	(02) amber, (03) blue, (04) red, (06) green	A,B,R,G	solid	24 VDC	Magnet
454202-24	(25) amber, (35) blue, (45) red, (05) white, (65) green	C	solid	24 VDC	Magnet
454300-XX	Specify Colors: (2) amber, (3) blue, (4) red, (5) white, (6) green	C	split	12 VDC	Suction-Magnet
454301-XX	Specify Colors: (2) amber, (3) blue, (4) red, (5) white, (6) green	C	split	12 VDC	Permanent
454302-XX	Specify Colors: (2) amber, (3) blue, (4) red, (5) white, (6) green	C	split	12 VDC	Magnet

*A=amber, B=blue, R=red, G=green, C=clear

Options - Permanent Mount Accessories	
SW2	Switch control
452340	Magnetic mount kit (includes cigarette lighter plug)
452341	Suction cup magnetic mount kit (includes cigarette lighter plug)
454217	Riser mount kit
454218	Flat mount kit
210883	Self-leveling bracket
If Desired, Choose Roof Mounting Bar	
210960-46	46" bar
210960-54	54" bar
210960-65	65" bar
454219	Roof mount bar kit (must be used when mounting on a Roof Mounting Bar)
Replacement Part	
Z8560109A	Magnetic wand keychain
Z8560095A-02	Replacement dome, amber
Z8560095A-03	Replacement dome, blue
Z8560095A-04	Replacement dome, red
Z8560095A-05	Replacement dome, clear

Specifications			
Flash Rate	Variable		
Voltage	12 VDC and 24 VDC		
Amp Draw*	5.0 max (solid color- 12 VDC)	3.0 max (solid color- 24 VDC)	6.0 max (split color)
Physical Specifications			
	Permanent mount	Magnetic mount	Suction-cup mount
Length	15.3 in (38.8 cm)		
Width	8.4 in (21.3 cm)		
Heights	2.7 in (6.6 cm)	3.0 in (7.6 cm)	3.0 in (7.6 cm)
Ship Weight			
	3.4 lbs (1.5 kg)	4.5 lbs (2.0 kg)	6.0 lbs (2.7 kg)

* Total amp draw depends upon flash pattern used.



Shown with multiple HighLighter LED mini-lightbars mounted on a box truck.



HIGHLIGHTER LED self-leveling bracket option.

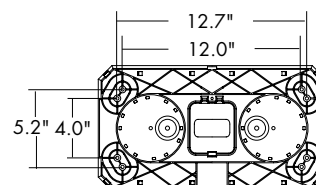

FEDERAL SIGNAL
Safety and Security Systems
Advancing security and well-being.

2645 Federal Signal Drive, University Park, IL 60466-3195
Police and Fire Tel.: (800) 264-3578 • Fax: (800) 682-8022
Amber Tel.: (800) 264-0254 • Fax: (800) 787-6237
www.fedsig.com

HighLighter, ROC, SOLARIS, and Magnet Select are trademarks of Federal Signal Corporation.

©2007 Federal Signal Corporation.